

Time and hours meters electromechanic

Hour counters with DIN dimensions

Display 7-digits, VDC trigger

B 160



B 160 for DC

Technical data - electrical ratings

Voltage supply	10...80 VDC
Power consumption	1.5 W
Running accuracy	<1 s / 24 h, stepping motor

Features

- Time and hour counter
- DC voltage
- 7-digit number wheel counter
- Counting capacity: 999999.9 h
- Without reset

Description

Baumer hour counters are applied anywhere to make costs become evident, to observe maintenance intervals, to define warranty periods or to record operation hours.

Technical data - mechanical design

Display	White numbers on black Decimal digits in red
Number of digits	7-digits
Digit height	4 mm
Counting capacity	999 999.9 h
Reading accuracy	1/10 h = 6 min
Ambient temperature	-20...+70 °C
Storage temperature	-20...+70 °C
Relative humidity	80 % non-condensing
Protection DIN EN 60529	IP 65 (face)
Housing type	Built-in housing Surface mount DIN rail housing EN 50022
Connection	Screw terminal connector
Mounting type	Clip frame for built-in housing DIN rail housing EN 50022
Dimensions W x H x L	48 x 48 x 38 mm
Cutout dimensions	45 x 45 mm (+0.6) ø51 mm
Mounting depth	38 mm
Weight approx.	110 g
Material	Housing: plastic

Time and hours meters electromechanic

Hour counters with DIN dimensions

Display 7-digits, VDC trigger

B 160

Part number

B 160. 00A CBB

Voltage / counting capacity
CBB 10...80 VDC / 999 999.9 h

Design

- 1 Built-in mounting with clip frame, front 48 x 48 mm or 55 x 55 mm with adapter frame (included in delivery)
- 4 Surface mount with adaptor for DIN rail EN 50022 (included in delivery)

Dimensions

Built-in counter with clip frame, front 48 x 48 mm

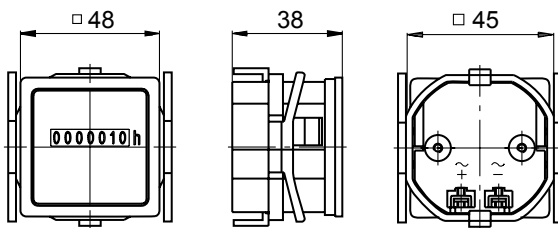

Surface mount with adaptor for DIN rail

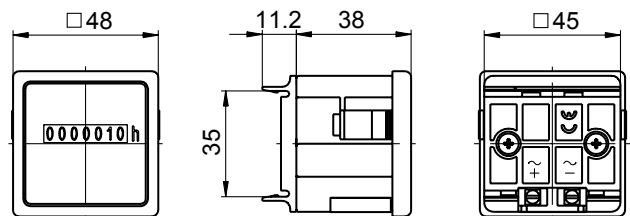

Adaptor frame for built-in counter, front 55 x 55 mm

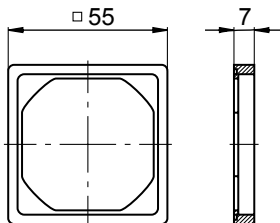

Installation steps

